

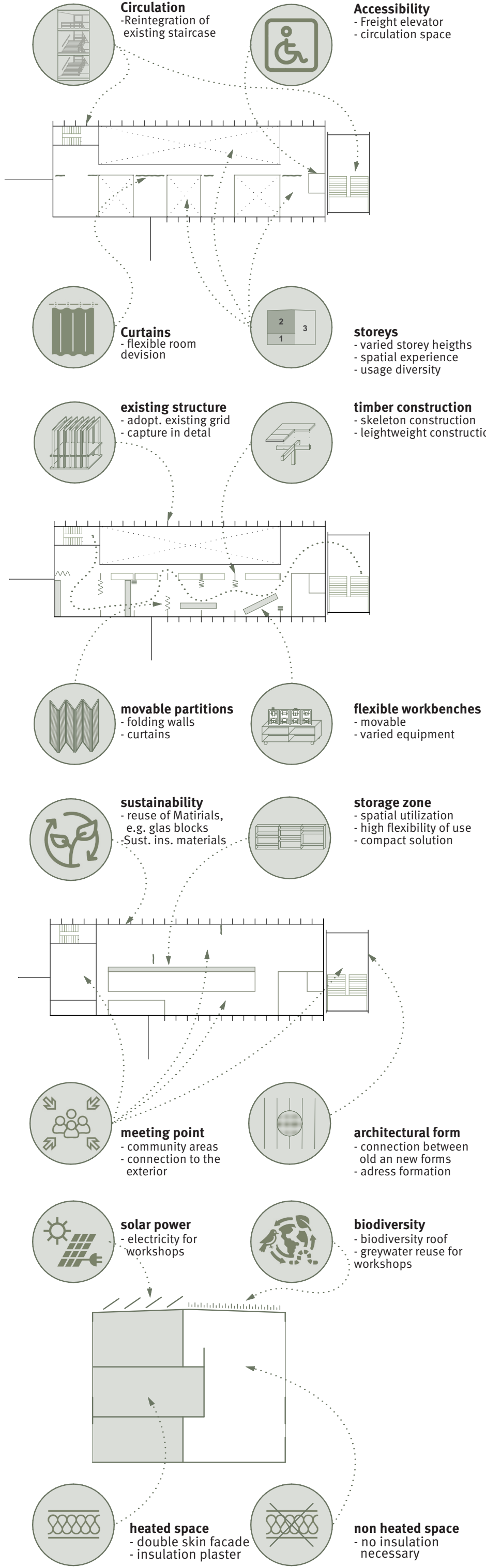

Space for various workshops - first floor

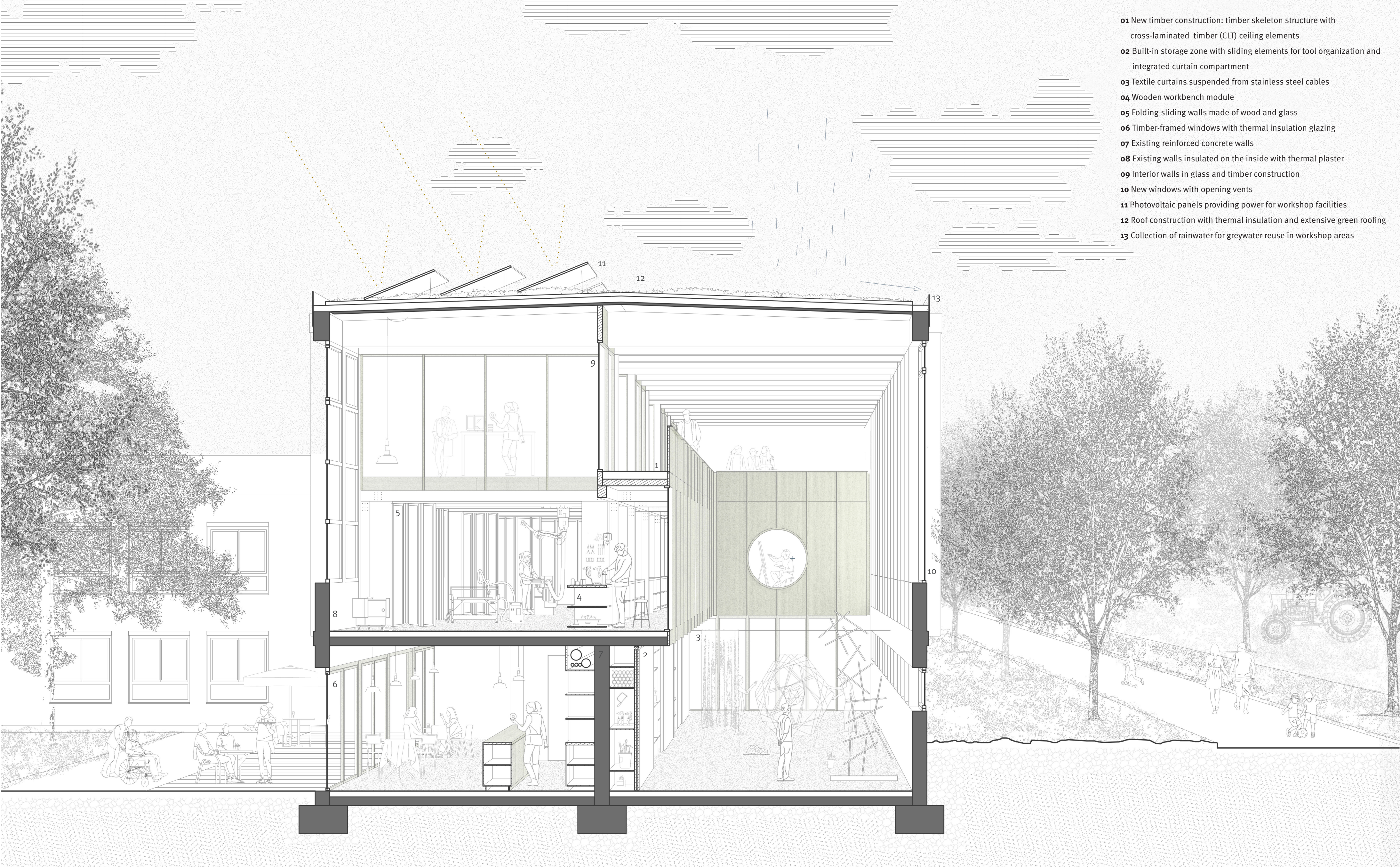

Flexibility of Space, Sustainability



- 01 New timber construction: timber skeleton structure with cross-laminated timber (CLT) ceiling elements
- 02 Built-in storage zone with sliding elements for tool organization and integrated curtain compartment
- 03 Textile curtains suspended from stainless steel cables
- 04 Wooden workbench module
- 05 Folding-sliding walls made of wood and glass
- 06 Timber-framed windows with thermal insulation glazing
- 07 Existing reinforced concrete walls
- 08 Existing walls insulated on the inside with thermal plaster
- 09 Interior walls in glass and timber construction
- 10 New windows with opening vents
- 11 Photovoltaic panels providing power for workshop facilities
- 12 Roof construction with thermal insulation and extensive green roofing
- 13 Collection of rainwater for greywater reuse in workshop areas

Cross section - hall, workshop, cafe M 1:50